

ALLOY CONNECTING LINKS

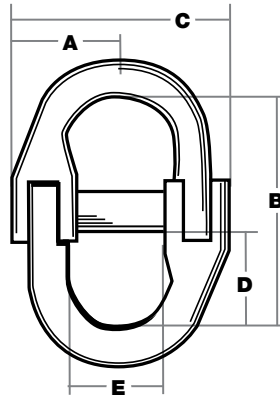

- Drop forged.
- Grade 80 alloy steel.
- Easy to assemble.
- Includes locking retaining pin.
- Painted finish.

| Indusco Part # | Trade Size | A | B | C | D | E | Weight Each | Working Load Limit* |
|----------------|------------|------|------|------|------|------|-------------|---------------------|
| 544 00001 | 1/4 (9/32) | .33 | 1.88 | 1.85 | .78 | .63 | .28 | 3,500 |
| 544 00004 | 5/16 | .36 | 2.18 | 1.97 | .91 | .66 | .33 | 4,500 |
| 544 00006 | 3/8 | .45 | 2.53 | 2.50 | 1.03 | .85 | .73 | 7,100 |
| 544 00011 | 1/2 | .59 | 3.36 | 3.22 | 1.44 | 1.09 | 1.67 | 12,000 |
| 544 00016 | 5/8 | .73 | 4.13 | 3.78 | 1.73 | 1.38 | 2.86 | 18,100 |
| 544 00021 | 3/4 | .91 | 4.56 | 4.66 | 2.09 | 1.62 | 5.00 | 28,300 |
| 544 00026 | 7/8 | 1.00 | 5.46 | 5.60 | 2.31 | 1.97 | 7.50 | 34,200 |
| 544 00031 | 1 | 1.18 | 5.98 | 6.19 | 2.50 | 2.25 | 11.03 | 47,700 |

*WORKING LOAD LIMIT IS BASED ON A DESIGN FACTOR OF 4:1

CALL **1-800-727-0665** TO PLACE AN ORDER
www.induscowirerope.com

WARNING Never exceed working load limit.

See pages 4 - 10 for important safety information.
All measurements/units listed are in inches/pounds unless otherwise noted.