

## BOLT AND NUT CHAIN SHACKLES

- Drop forged.
- Hot dipped galvanized.
- Meets design requirements of Federal Specification RR-C-271 Type IV B Grade A Class 3.
- See Warnings “**Shackles**” on Page 7 for proper use and selection.

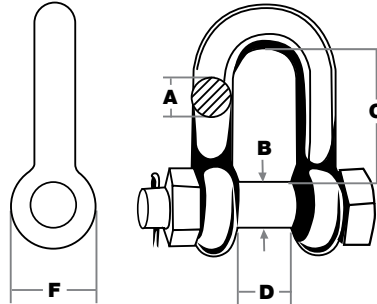

Indusco Part #	A Nominal Size	B Pin Dia.	C	D	F	Weight Each	Working Load Limit*
751 00571	1/2	.63	1.69	.81	1.31	.75	4,000
751 00572	5/8	.75	2.00	1.06	1.56	1.50	6,500
751 00573	3/4	.88	2.31	1.25	1.88	2.50	9,500
751 00591	7/8	1.00	2.81	1.44	2.13	3.85	13,000
751 00606	1	1.13	3.25	1.69	2.38	5.55	16,000
751 00612	1-1/8	1.25	3.50	1.81	2.75	7.60	19,000
751 00616	1-1/4	1.38	3.69	2.00	3.00	10.80	24,000
751 00626	1-3/8	1.50	4.50	2.25	3.13	14.00	27,000
751 00631	1-1/2	1.63	5.00	2.38	3.50	19.00	34,000
751 00637	1-3/4	2.00	5.88	2.88	4.00	31.40	50,000
751 00639	2	2.25	6.75	3.25	4.88	46.80	70,000
751 00641	2-1/2	2.75	8.06	4.13	5.50	83.50	110,000

\*WORKING LOAD LIMIT IS BASED ON A DESIGN FACTOR OF 5:1

CALL **1-800-727-0665** TO PLACE AN ORDER  
[www.induscowirerope.com](http://www.induscowirerope.com)

**WARNING** Never exceed working load limit.

See pages 4 - 10 for important safety information.  
 All measurements/units listed are in inches/pounds unless otherwise noted.