

## BOLT AND NUT ANCHOR SHACKLES

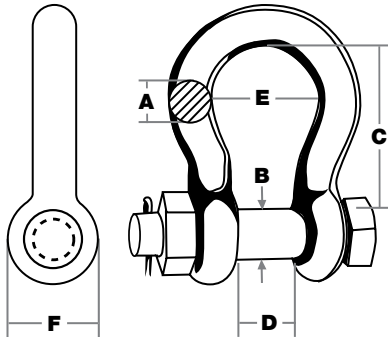

- Meets design requirements of Federal Specifications RR-C-271 Type IV A Grade A Class 3.
- See Warnings **“Shackles”** on Page 7 for proper use and selection.

| Indusco Part #                           | A<br>Nominal Size | B<br>Pin Dia. | C     | D    | E    | F    | Weight<br>Each | Working Load<br>Limit*  |
|--|-------------------|---------------|-------|------|------|------|----------------|-------------------------|
| <b>DROP FORGED-HOT DIPPED GALVANIZED</b> |                   |               |       |      |      |      |                |                         |
| 751 00809                                | 3/8               | .43           | 1.50  | .65  | 1.03 | .96  | .33            | 2,000                   |
| 751 00436                                | 1/2               | .63           | 2.00  | .81  | 1.31 | 1.31 | .79            | 4,000                   |
| 751 00446                                | 5/8               | .75           | 2.50  | 1.0  | 1.69 | 1.56 | 1.68           | 6,500                   |
| 751 00456                                | 3/4               | .88           | 3.00  | 1.25 | 2.00 | 1.88 | 2.72           | 9,500                   |
| 751 00466                                | 7/8               | 1.00          | 3.25  | 1.44 | 2.25 | 2.13 | 3.95           | 13,000                  |
| 751 00476                                | 1                 | 1.13          | 3.75  | 1.69 | 2.50 | 2.38 | 5.80           | 17,000                  |
| 751 00486                                | 1-1/8             | 1.25          | 4.25  | 1.81 | 2.94 | 2.63 | 8.27           | 19,000                  |
| 751 00496                                | 1-1/4             | 1.38          | 4.50  | 2.00 | 3.25 | 3.00 | 11.70          | 24,000                  |
| 751 00506                                | 1-3/8             | 1.50          | 5.25  | 2.25 | 3.50 | 3.25 | 15.80          | 27,000                  |
| 751 00516                                | 1-1/2             | 1.63          | 5.75  | 2.38 | 3.88 | 3.50 | 20.00          | 34,000                  |
| 751 00526                                | 1-3/4             | 2.00          | 7.00  | 2.88 | 4.75 | 4.00 | 33.90          | 50,000                  |
| 751 00536                                | 2                 | 2.25          | 7.75  | 3.25 | 5.75 | 4.88 | 52.00          | 70,000                  |
| 751 00546                                | 2-1/2             | 2.75          | 10.56 | 4.13 | 7.25 | 5.50 | 98.00          | 110,000                 |
| 751 00556                                | 3                 | 3.25          | 13.13 | 5.00 | 8.00 | 6.50 | 154.00         | 170,000                 |
| <b>STAINLESS STEEL - (TYPE 316)</b>      |                   |               |       |      |      |      |                |                         |
| Indusco Part #                           | A<br>Nominal Size | B<br>Pin Dia. | C     | D    | E    | F    | Weight<br>Each | Working Load<br>Limit** |
| 751 01010                                | 3/8               | .44           | 1.44  | .69  | 1.00 | .94  | .30            | 1,500                   |
| 751 01016                                | 7/16              | .50           | 1.75  | .75  | 1.06 | 1.13 | .44            | 2,000                   |
| 751 01021                                | 1/2               | .63           | 1.94  | .81  | 1.25 | 1.25 | .72            | 3,000                   |
| 751 01026                                | 5/8               | .75           | 2.44  | 1.06 | 1.63 | 1.63 | 1.60           | 4,000                   |
| 751 01031                                | 3/4               | .88           | 3.00  | 1.25 | 1.88 | 1.88 | 2.70           | 6,000                   |

\*WORKING LOAD LIMIT IS BASED ON A DESIGN FACTOR OF 5:1

**CALL 1-800-727-0665 TO PLACE AN ORDER**  
[www.induscowirerope.com](http://www.induscowirerope.com)

**⚠ WARNING** Never exceed working load limit.

See pages 4 - 10 for important safety information.  
 All measurements/units listed are in inches/pounds unless otherwise noted.