

SCREW PIN ANCHOR SHACKLES

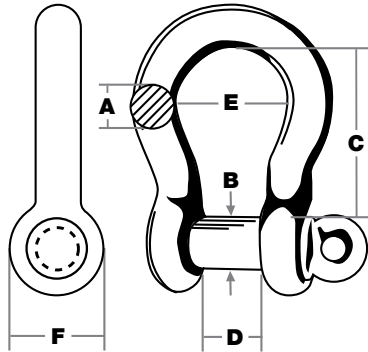

- Hot dipped galvanized.
- Meets design requirements of Federal Specification RR-C-271 Type IV A Grade A Class 2.
- See Warnings “**Shackles**” on Page 7 for proper use and selection.

Indusco Part #	A Nominal Size	B Pin Dia.	C	D	E	F	Weight Each	Working Load Limit*
DROP FORGED - HOT DIPPED GALVANIZED								
751 00066	3/16	.25	.75	.38	.59	.56	.06	650
751 00076	1/4	.31	1.13	.47	.78	.69	.10	1,000
751 00091	5/16	.38	1.25	.53	.84	.81	.19	1,500
751 00106	3/8	.44	1.50	.66	1.03	.97	.31	2,000
751 00121	7/16	.50	1.75	.72	1.16	1.13	.38	3,000
751 00131	1/2	.63	2.00	.81	1.31	1.31	.70	4,000
751 00146	5/8	.75	2.50	1.06	1.69	1.56	1.38	6,500
751 00161	3/4	.88	3.00	1.25	2.00	1.88	2.25	9,500
751 00176	7/8	1.00	3.25	1.44	2.25	2.13	3.62	13,000
751 00191	1	1.13	3.75	1.69	2.50	2.38	5.00	17,000
751 00206	1-1/8	1.25	4.25	1.81	2.94	2.63	7.40	19,000
751 00216	1-1/4	1.38	4.50	2.00	3.25	3.00	9.50	24,000
751 00226	1-3/8	1.50	5.25	2.25	3.50	3.25	13.25	27,000
751 00236	1-1/2	1.63	5.75	2.38	3.88	3.50	17.20	34,000
751 00246	1-3/4	2.00	7.00	2.88	4.75	4.00	30.30	50,000
751 00256	2	2.25	7.75	3.25	5.75	4.88	45.00	70,000
751 00266	2-1/2	2.75	10.56	4.13	7.25	5.50	85.70	110,000

*WORKING LOAD LIMIT IS BASED ON A DESIGN FACTOR OF 5:1

CALL 1-800-727-0665 TO PLACE AN ORDER
www.induscowirerope.com

⚠ WARNING Never exceed working load limit.

See pages 4 - 10 for important safety information.
 All measurements/units listed are in inches/pounds unless otherwise noted.

SCREW PIN ANCHOR SHACKLES

- Meets design requirements of Federal Specification RR-C-271 Type IV A Class 2.
- See Warnings “**Shackles**” on Page 7 for proper use and selection.

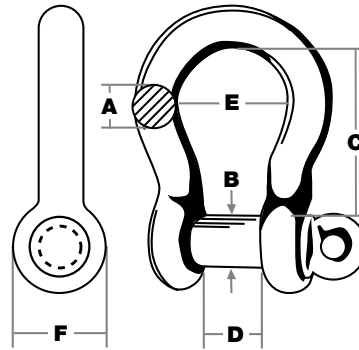

Indusco Part #	A Nominal Size	B Pin Dia.	C	D	E	F	Weight Each	Working Load Limit*
STAINLESS STEEL- (TYPE 316)								
751 00073	3/16	.25	.75	.38	.59	.56	.05	650
751 00086	1/4	.31	1.13	.47	.78	.69	.10	1,000
751 00101	5/16	.38	1.25	.53	.84	.81	.18	1,300
751 00116	3/8	.44	1.50	.66	1.03	.97	.30	1,500
751 00128	7/16	.50	1.75	.72	1.16	1.13	.35	2,000
751 00141	1/2	.63	2.00	.81	1.31	1.31	.65	3,000
751 00156	5/8	.75	2.50	1.06	1.69	1.56	1.30	4,420
751 00171	3/4	.88	3.00	1.25	2.00	1.88	2.16	6,000
751 00190	7/8	1.00	3.25	1.44	2.25	2.13	3.50	8,000
751 00205	1	1.13	3.75	1.69	2.50	2.38	5.00	10,000

*WORKING LOAD LIMIT IS BASED ON A DESIGN FACTOR OF 5:1

CALL **1-800-727-0665** TO PLACE AN ORDER
www.induscowirerope.com

⚠ WARNING Never exceed working load limit.

See pages 4 - 10 for important safety information.
 All measurements/units listed are in inches/pounds unless otherwise noted.