

OPEN SWAGE SOCKETS

- Self-colored.
- In accordance with ANSI B30.9, all slings terminated with swage sockets shall be proof-tested.
- When attached properly, these sockets will meet 100% of the wire rope rated capacity.

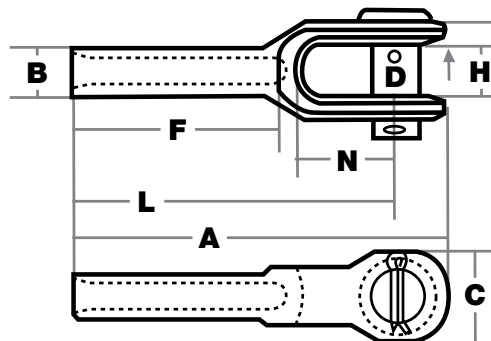

Indusco Part #	Trade Size	A	B	C	D	F	H	L	N	Weight Each
787 00206	1/4	4.78	.50	1.38	.69	2.19	.69	4.00	1.47	.52
787 00211	5/16	6.30	.78	1.62	.81	3.25	.80	5.34	1.67	1.12
787 00216	3/8	6.30	.78	1.62	.81	3.25	.80	5.34	1.67	1.30
787 00218	7/16	7.82	1.01	2.00	1.00	4.31	1.00	6.69	1.96	2.08
787 00221	1/2	7.82	1.01	2.00	1.00	4.31	1.00	6.69	1.96	2.08
787 00223	9/16	9.54	1.27	2.38	1.19	5.38	1.25	8.13	2.21	4.67
787 00226	5/8	9.54	1.27	2.38	1.19	5.38	1.25	8.13	2.21	4.51
787 00231	3/4	11.61	1.56	2.75	1.38	6.44	1.50	10.00	2.69	7.97
787 00236	7/8	13.37	1.72	3.13	1.63	7.50	1.75	11.63	3.20	11.52
787 00241	1	15.47	2.00	3.69	2.00	8.63	2.00	13.38	3.68	17.80
787 00246	1-1/8	17.35	2.25	4.06	2.25	9.75	2.25	15.00	4.18	25.25
787 00251	1-1/4	19.20	2.53	4.50	2.50	10.81	2.50	16.50	4.64	35.56
787 00256	1-3/8	21.10	2.81	5.25	2.50	11.88	2.41	18.13	5.25	43.75
787 00261	1-1/2	23.17	3.08	5.50	2.75	12.94	3.00	19.75	5.70	58.50
787 00266	1-3/4	26.70	3.40	6.25	3.50	15.06	3.50	23.00	6.67	88.75
787 00288	2	31.15	3.94	7.80	3.75	17.06	4.00	26.75	8.19	146.20

Larger sizes available up to 4"

WEIGHTS AND DIMENSIONS MAY VARY DUE TO MANUFACTURER TOLERANCES

CALL **1-800-727-0665** TO PLACE AN ORDER
www.induscowirerope.com

⚠ WARNING Never exceed working load limit.

See pages 4 - 10 for important safety information.
 All measurements/units listed are in inches/pounds unless otherwise noted.